

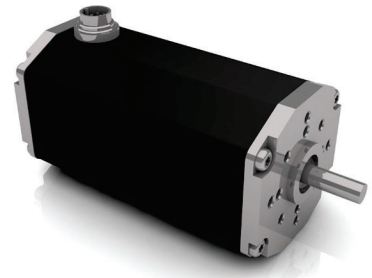





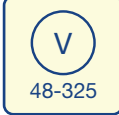

» BG 65 dCore | cont. 140 W, peak 390 W

- » Highly dynamic 3-phase EC motor with 10-pole magnet
- » Hall sensors for rotor position detection
- » On request, this motor can be manufactured with different voltage versions

- » Hochdynamischer 3-strängiger EC-Motor mit 10-poligem Magnet
- » Hallsensoren zur Rotorlageerfassung
- » Diese Motoren werden auf Anfrage mit anderen Spannungsvarianten hergestellt



						
Feedback integrated	Supply voltage versions	High efficiency	Protection class (up to)	Certification	Certification (>36 V only)	Vibration resistance

Data preliminary/ Technische Daten vorläufig		BG 65x25 dCore		BG 65x50 dCore		BG 65x75 dCore	
Nominal voltage/ Nennspannung	VDC	24	48	24	48	48	325
Nominal current/ Nennstrom	A ¹⁾	6	2.8	7.7	4.2	5.1	0.62
Nominal torque/ Nennmoment	Nm ¹⁾	0.184	0.24	0.39	0.43	0.55	0.39
Nominal speed/ Nenndrehzahl	rpm ¹⁾	4450	4130	3470	3560	3390	3500
Stall torque/ Anhaltmoment	Nm ¹⁾	0.97	0.97	1.63	1.63	3.30	3.30
Maximum torque/ Maximales Moment	Nm ¹⁾	0.97	0.97	1.63	1.63	3.30	3.30
No load speed/ Leerlaufdrehzahl	rpm ¹⁾	8180	7720	6190	6430	5870	6160
Nominal output power/ Dauerabgabeleistung	W ¹⁾	86	106	142	160	195	140
Maximum output power/ Maximale Abgabeleistung	W	173	175	261	276	391	260
Torque constant/ Drehmomentkonstante	Nm A ⁻¹ ¹⁾	0.053	0.116	0.069	0.142	0.147	0.12
Rotor inertia/ Rotor Trägheitsmoment	gcm ²	71.6	71.6	128	128	172	172
Weight of motor/ Motorgewicht	kg	0.87	0.87	1.3	1.3	1.8	1.8

*) $\Delta\vartheta_w = 100\text{ K}$; **) $\vartheta_r = 20^\circ\text{C}$ ***) at nominal point/ im Nennpunkt

Modular System/ Modulares Baukastensystem

» Brakes/ Bremsen

- E 90
- E 100

» Encoder/ Geber

- RE 30 (TI)
- RE 56 (TI)
- AE 38
- R 37

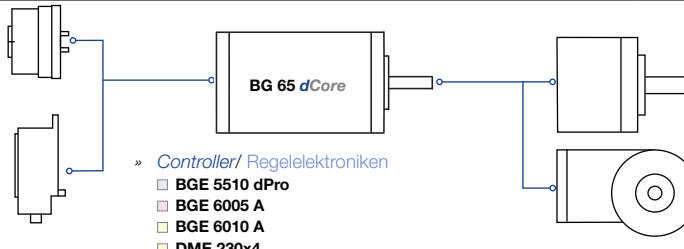

» Controller/ Regelelektroniken

- BGE 5510 dPro
- BGE 6005 A
- BGE 6010 A
- DME 230x4

» Planetary Gearboxes/ Planetengetriebe

<input type="checkbox"/> PLG 52	<input type="checkbox"/> PLG 52 H
<input type="checkbox"/> PLG 60	<input type="checkbox"/> PLG 63 EP
<input type="checkbox"/> PLG 63 HT	<input type="checkbox"/> PLG 75 EP
<input type="checkbox"/> PLG 60 LB	

» Angular Gearboxes/ Winkelgetriebe

<input type="checkbox"/> SG 80	<input type="checkbox"/> SG 120
<input type="checkbox"/> STG 65	<input type="checkbox"/> KG 80

» Accessories/ Zubehör

- Cover / Verschlussdeckel

You can individually configure your suitable product and download technical data and drawings for the combination at www.dunkermotoren.com/en/configuration/
 Unter www.dunkermotoren.de/konfigurator können Sie Ihr passendes Produkt individuell konfigurieren und technische Daten und Zeichnung für die Kombination herunterladen.

Dimensions in mm/ Maßzeichnung in mm

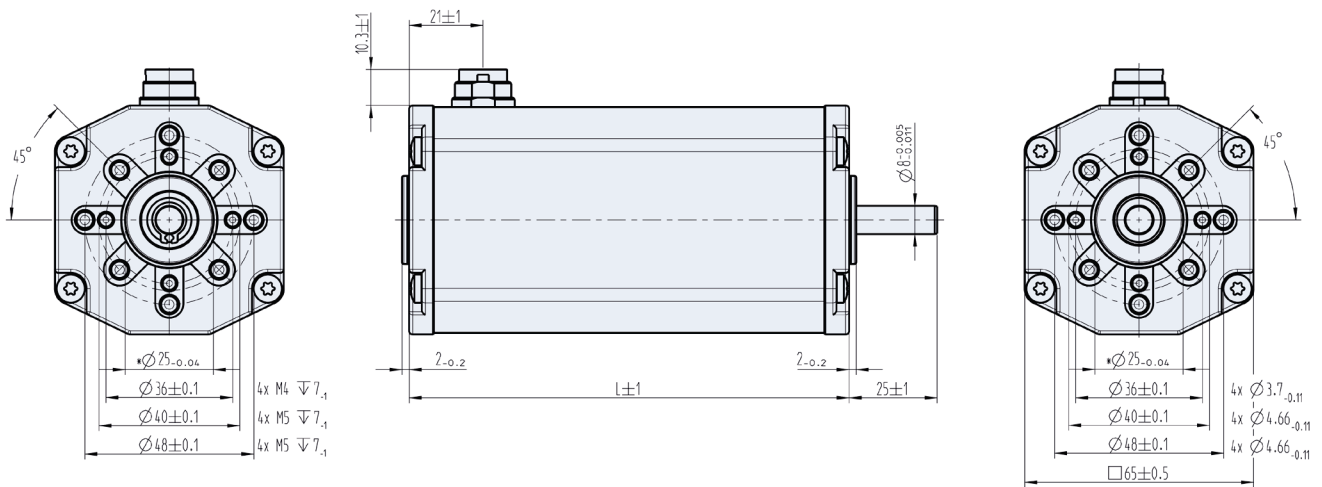

Characteristic diagram/ Belastungskennlinien*

In accordance with/ Belastungskennlinien gezeichnet nach EN 60034

■ Continuous operation/ Dauerbetrieb ■ Cyclical operation/ Zykl. Betrieb — Current torque/ Strom-Drehmoment — Speed torque/ Drehzahl-Drehmoment — Efficiency/ Effizienz

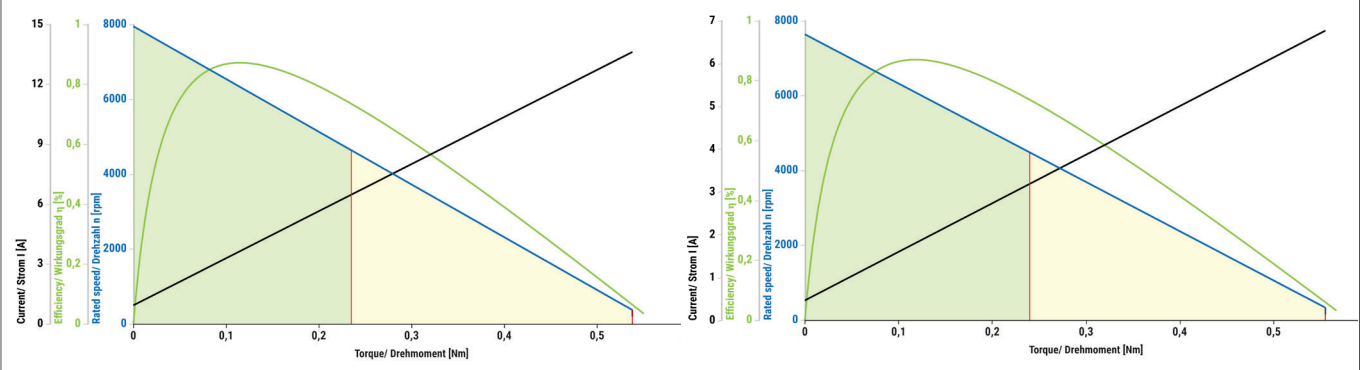

BG 65x25 dCore, 24V

BG 65x25 dCore, 48V

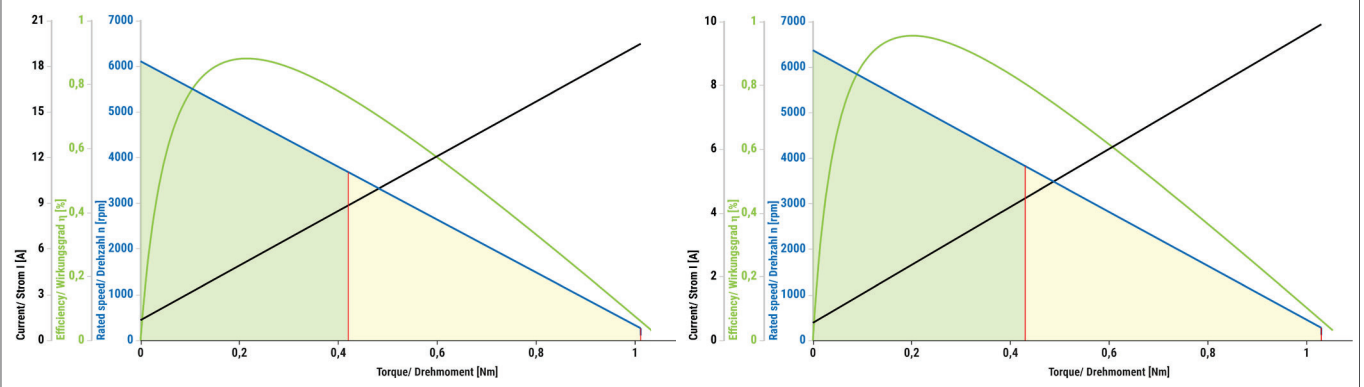

BG 65x50 dCore, 24V

BG 65x50 dCore, 48V

* Preliminary data/ Vorläufige Daten

■ Preferred series/ Vorzugsreihe ■ Standard product/ Standardprodukt ■ On request/ auf Anfrage See notes page 8/ Hinweise siehe S. 8

BG motors