





Contents ▶▶

A Information

- A-01 Product Coding System
- A-04 Products Lineup
- A-08 General Information
- A-12 Terminology
- A-15 Caution for Using

B AC Motors

- B-01 Technical Data of AC Motor
- B-06 Induction Motor
- B-48 2 Pole Motor
- B-66 Reversible Motor
- B-98 Electromagnetic Brake Motor
- B-138 Clutch & Brake Motor
- B-154 Torque Motor
- B-168 Speed Control System
 - B-171 Speed Controller FX1000A
 - B-173 Speed Controller DSK
 - B-175 Speed Controller DSKS
 - B-178 Speed Control Induction Motor
 - B-212 Speed Control Reversible Motor
 - B-240 Speed Control E.M. Brake Motor
 - B-266 Speed Control Clutch & Brake Motor

C DC Motors

- C-01 Technical Data of DC Motor
- C-04 DC Motor
- C-17 Speed Controller DSD-90

D Gearheads

- D-01 Technical Data of Gearhead
- D-07 Parallel Gearhead
- D-12 Worm Gearhead
- D-14 Inter-decimal Gearhead

E Options

- E-01 Mounting Plate
- E-02 Extension Cable
- E-03 Output Flange / Output Shaft

E Options

Mounting Plate

Mounting Plate

It enables motor/gearhead to be mounted on installation place.
There are mounting plates of frame size □70/80/90mm for motor and gearhead.



Product Code

D	BK	M	70
Brand D : DKM	Product BK : Bracket	Attaching Item M : Motor G : Gearhead	Frame Size 70 : □70mm Motor / Gearhead 80 : □80mm Motor / Gearhead 90 : □90mm Motor / Gearhead

Dimensions

For Frame Size □70mm

● Model: DBKG-70

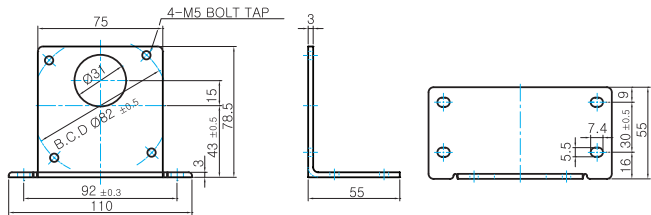

● Model: DBKM-70

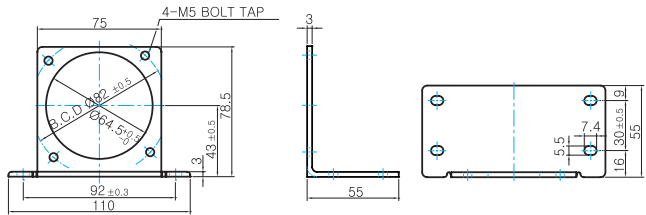

For Frame Size □80mm

● Model: DBKG-80

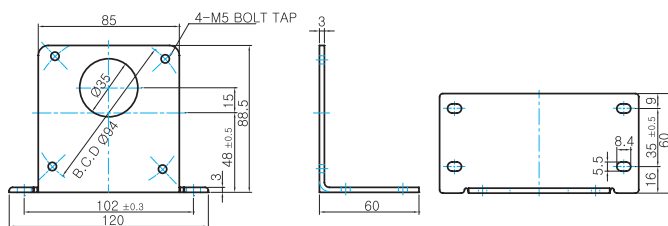

● Model: DBKM-80

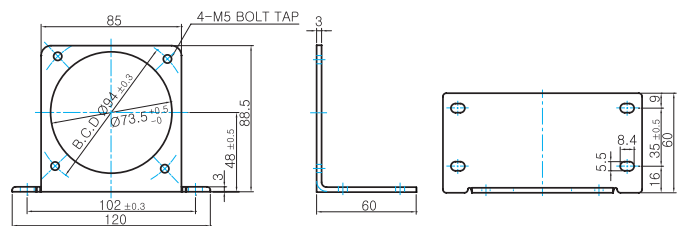

For Frame Size □90mm

● Model: DBKG-90

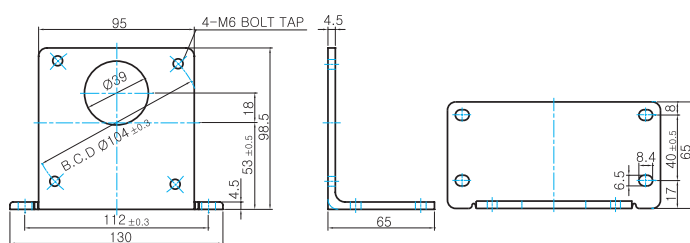

● Model: DBKM-90

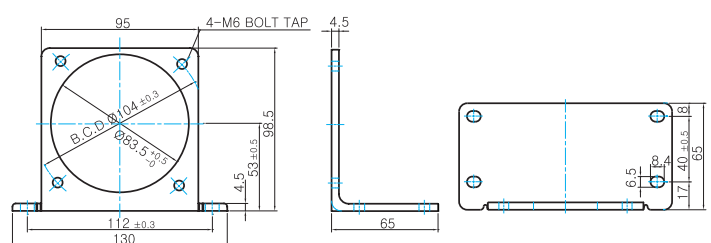



Extension Cable

This is for the connection between speed control motor and speed controller.
The basic length of extension cable is 0.3m. So if longer needed,
please order the cable additionally. There are 0.5/1.0/1.5/2.0/3.0/5.0m extension cables.



Dimension

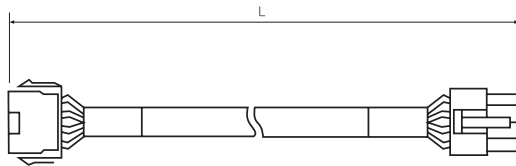

MODEL	Length of cable (L)
DEW-05	0.5m
DEW-10	1.0m
DEW-15	1.5m
DEW-20	2.0m
DEW-30	3.0m
DEW-50	5.0m



E Options

Output Flange / Output Shaft

Output Flange

It is available to fix/install worm hollow type gearhead by attaching output flange to the gearhead.

Dimensions

● MODEL: WHG-030-F

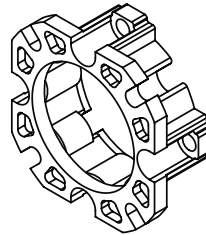
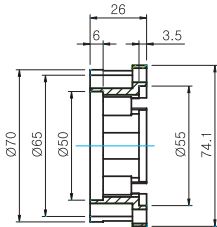
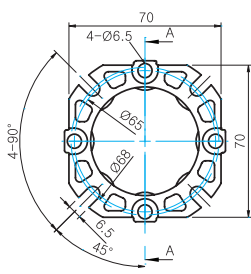

Output Shaft

These are output shafts to be attached to worm hollow type gearhead. There are unidirectional output shaft and bi-directional output shaft.

Dimensions

● Unidirectional MODEL: 15X92L

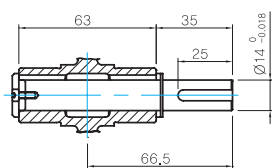

● Bi-directional MODEL: 14X135L

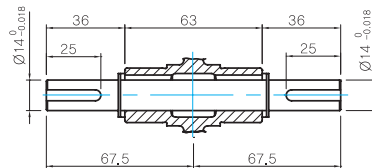

● KEY SPEC

