



Contents ▶▶

A Information

- A-01 Product Coding System
- A-04 Products Lineup
- A-08 General Information
- A-12 Terminology
- A-15 Caution for Using

B AC Motors

- B-01 Technical Data of AC Motor
- B-06 Induction Motor
- B-56 2 Pole Motor
- B-74 Reversible Motor
- B-106 Brake Motor
- B-148 Clutch & Brake Motor
- B-162 Torque Motor
- B-176 Speed Control System
 - B-179 Speed Controller FX1000A
 - B-181 Speed Controller DSKM
 - B-186 Speed Control Induction Motor
 - B-222 Speed Control Reversible Motor
 - B-250 Speed Control Brake Motor
 - B-276 Speed Control Clutch & Brake Motor

C DC Motors

- C-01 Technical Data of DC Motor
- C-04 DC Motor
- C-17 Speed Controller DSD-90

D Gearboxes

- D-01 Technical Data of Gearbox
- D-07 Parallel Gearbox
- D-13 Worm Gearbox
- D-16 Inter-decimal Gearbox

E Options

- E-01 Mounting Plate
- E-02 Extension Cable
- E-03 Output Flange / Output Shaft

E Options

Mounting Plate

Mounting Plate

It enables motor/Gearbox to be mounted on installation place.
There are mounting plates of frame size □70/80/90mm for motor and Gearbox.



Product Code

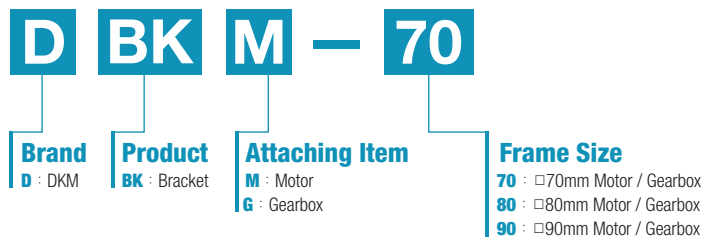

Dimensions

For Frame Size □70mm

● Model: DBKG-70

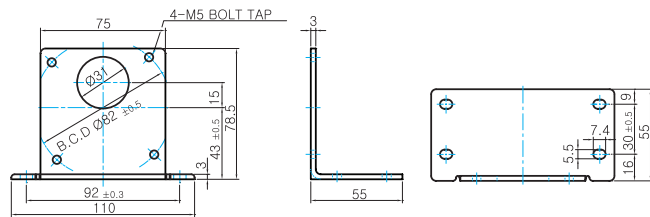

● Model: DBKM-70

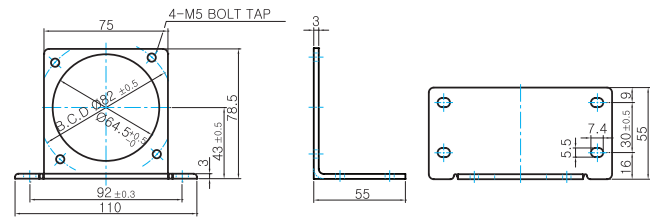

For Frame Size □80mm

● Model: DBKG-80

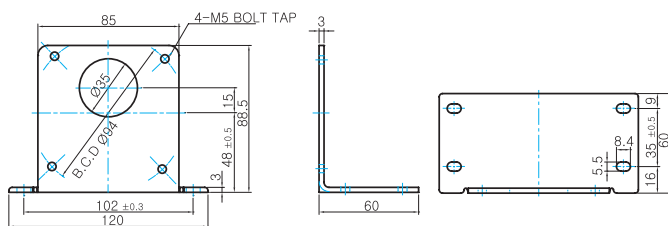

● Model: DBKM-80

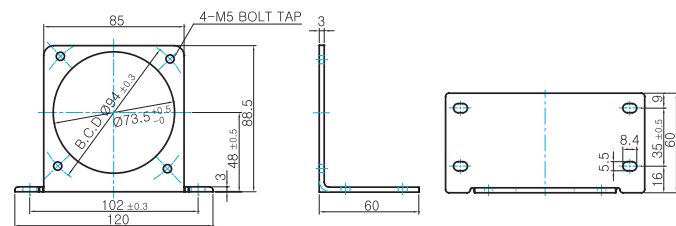

For Frame Size □90mm

● Model: DBKG-90

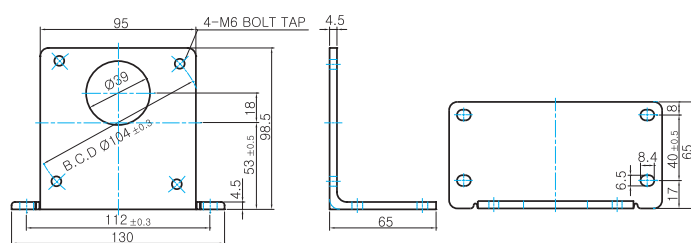

● Model: DBKM-90

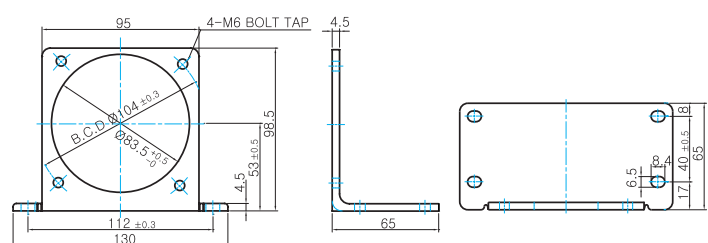

Extension Cable

This is for the connection between speed control motor and speed controller.
 The basic length of extension cable is 0.3m. So if longer needed,
 please order the cable additionally. There are 0.5/1.0/1.5/2.0/3.0/5.0m extension cables.



Dimension

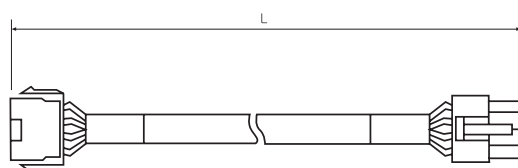

MODEL	Length of cable (L)
DEW-05	0.5m
DEW-10	1.0m
DEW-15	1.5m
DEW-20	2.0m
DEW-30	3.0m
DEW-50	5.0m

E Options

Output Flange / Output Shaft

Output Flange

It is available to fix/install worm hollow type Gearbox by attaching output flange to the Gearbox.

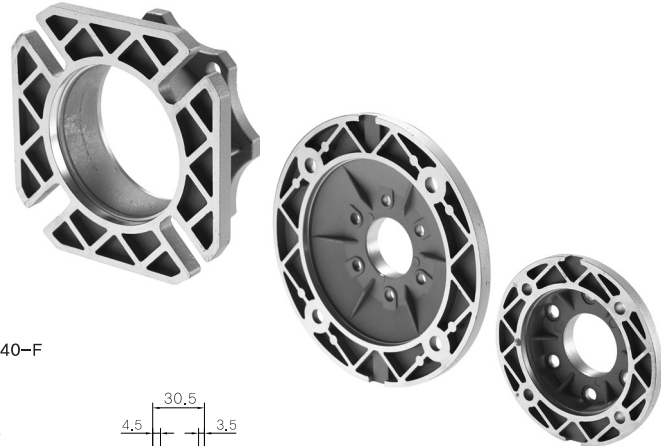

Dimensions

● MODEL: WHG-030-F

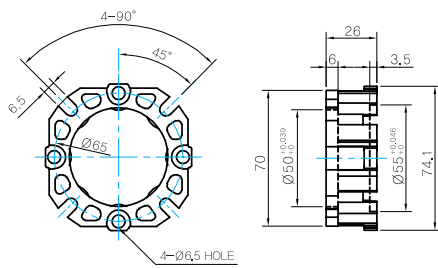

● MODEL: WHG-040-F

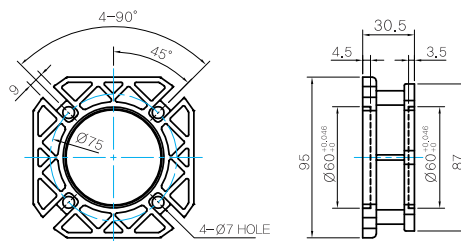

● MODEL: 040-Flange-71B5

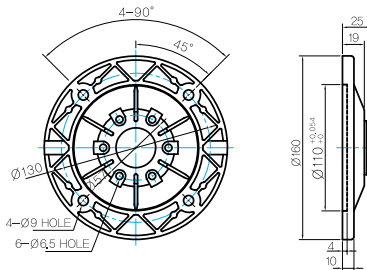

● MODEL: 040-Flange-71B14

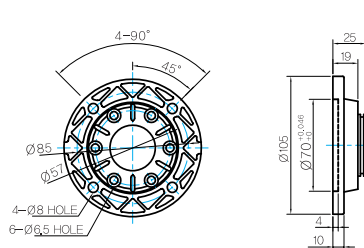

Output Shaft

These are output shafts to be attached to worm hollow type Gearbox.
There are unidirectional output shaft and bi-directional output shaft.



Dimensions

● Unidirectional MODEL: 030-Shaft-S ● Bi-directional MODEL: 030-Shaft-D

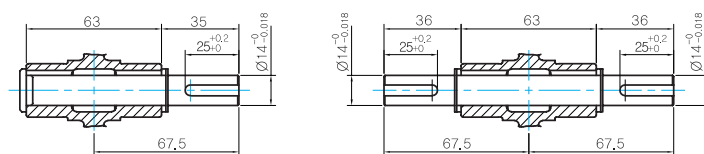

● KEY SPEC

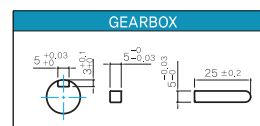

● Unidirectional MODEL: 040-Shaft-S ● Bi-directional MODEL: 040-Shaft-D

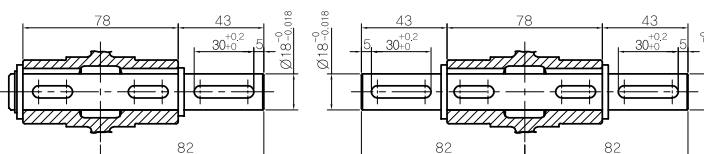

● KEY SPEC

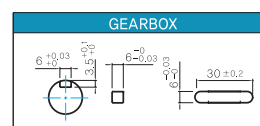

MEMO



MEMO

