

- » Outstanding radial load capacity
- » Nearly no installation space required, as integrated in the hub
- » Durable robust design
- » Optional wheel lining in special materials

- » Herausragende Radialbelastbarkeit
- » Nahezu kein Bauraumbedarf, da in Nabe integriert
- » Langlebiges robustes Design
- » Optional Radbelag in Sonderwerkstoffen



Lifetime lubrication



High efficiency



Protection class



Vibration resistance



High torque



Longlife version

Data/ Technische Daten | NG 500

Reduction ratio/ Untersetzungsverhältnis	-	4	5	8	16	20	32
Efficiency/ Wirkungsgrad	%	90			85		
Number of stages/ Stufenzahl	-	1			2		
Continuous torque/ Dauerdrehmoment	Nm	21	16	18	21		
Acceleration torque/ Beschleunigungsmoment	Nm	42	32	36	42		
Emergency stop torque/ Not-Aus Drehmoment	Nm	63	48	54	63		
Operating mode/ Betriebsart	-	S1 / S8					
Max. backlash/ Max. Verdrehspiel	arc-min	45			40		
Weight of gearbox/ Getriebege wicht	kg	7.8			9.2		
Axial load/ radial load/ Axiallast/ Radiallast	N	1667 / 5000					

Dimensions BG 95x40 dCore + NG 500 in mm/ Maßzeichnung BG 95x40 dCore + NG 500 in mm

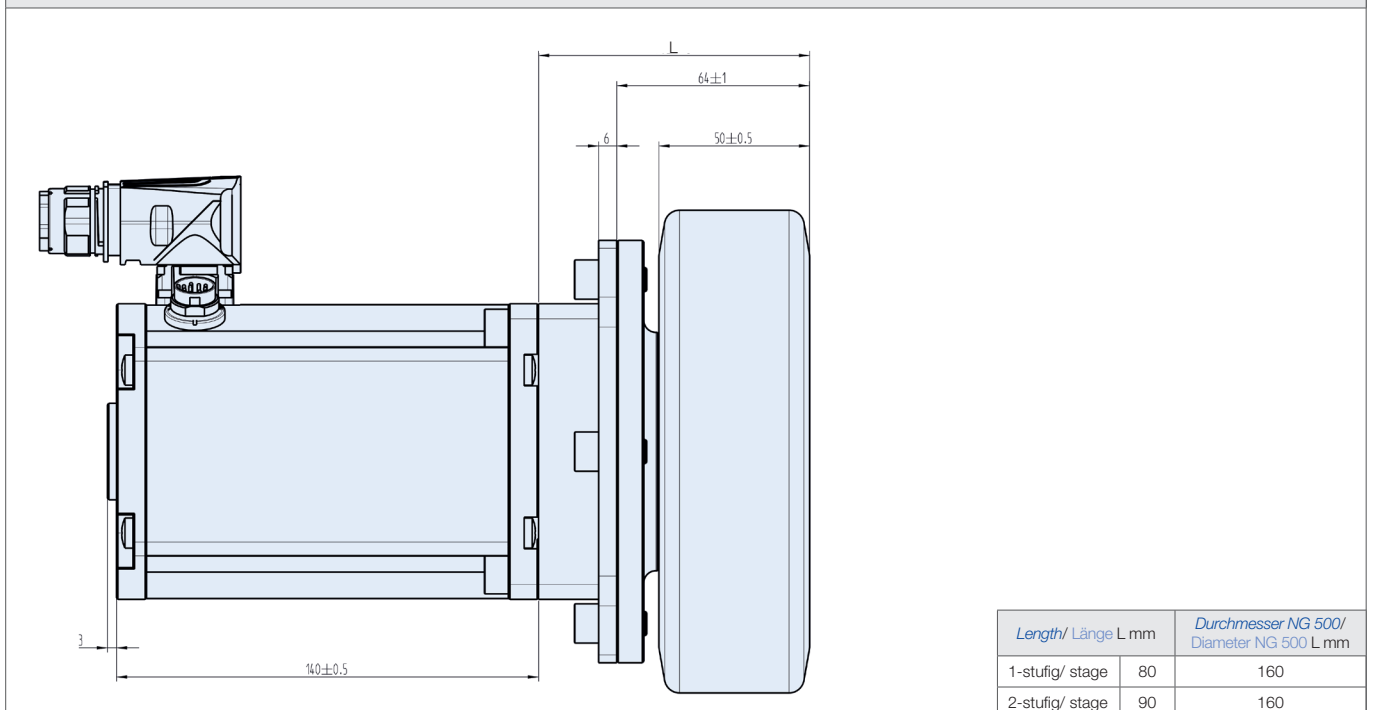

Dimensions BG 75x50 dPro + NG 500 in mm/ Maßzeichnung BG 75x50 dPro + NG 500 in mm

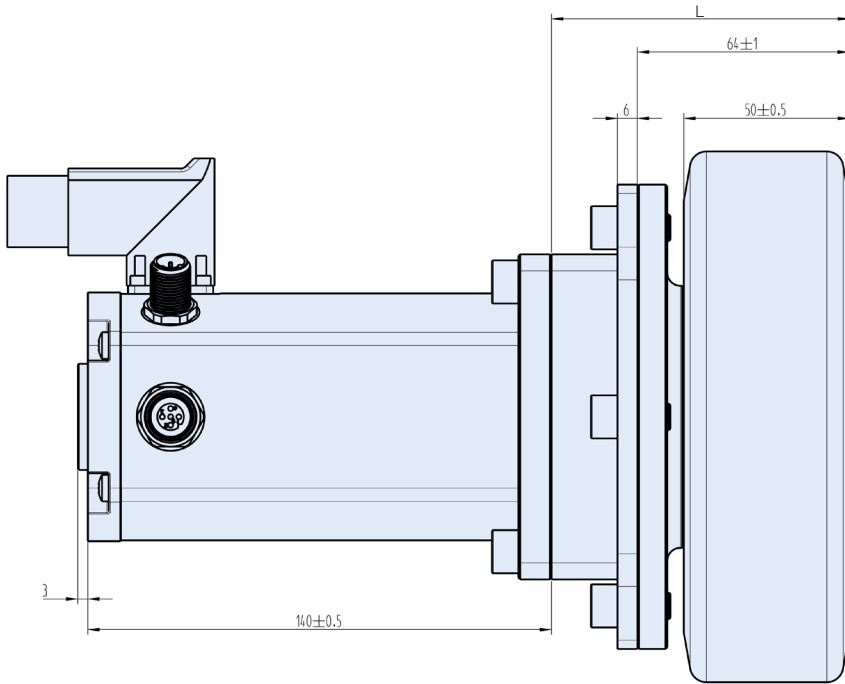

Length/ Länge L mm		Durchmesser NG 500/ Diameter NG 500 L mm
1-stufig/ stage	80	160
2-stufig/ stage	90	160

Dimensions NG 500 in mm/ Maßzeichnung NG 500 in mm

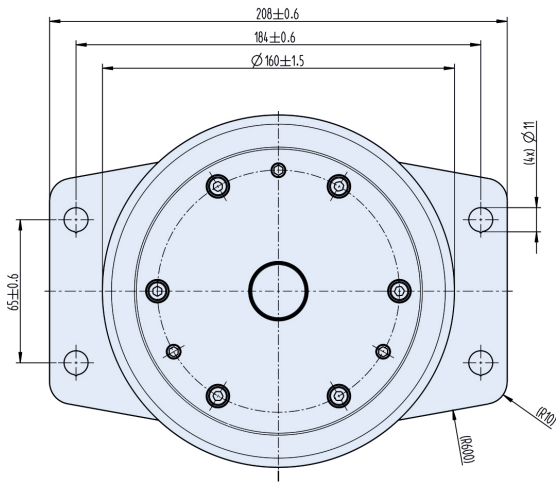

Wheel side/ Radseite

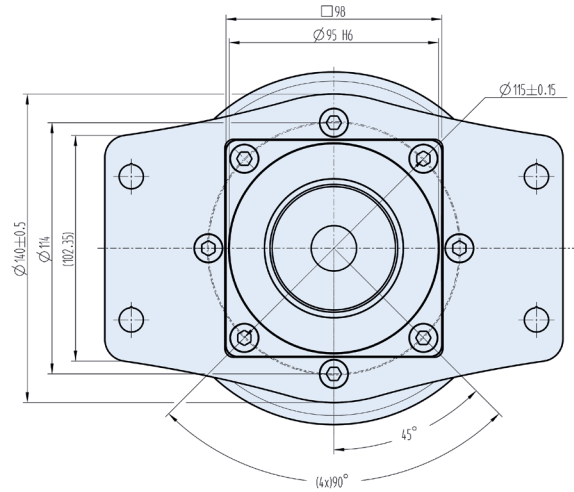

Motor side/ Motorseite